

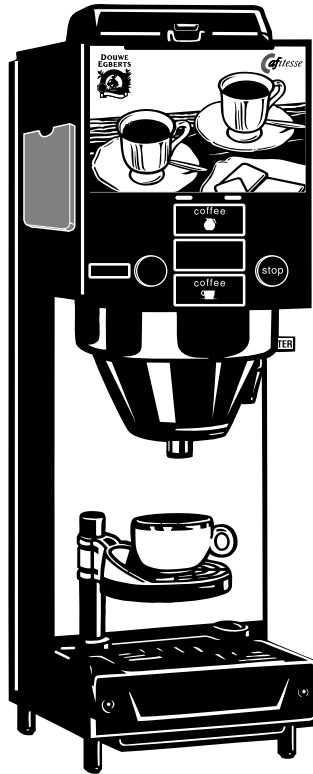

Quick Reference Cards

Cafitesse 110





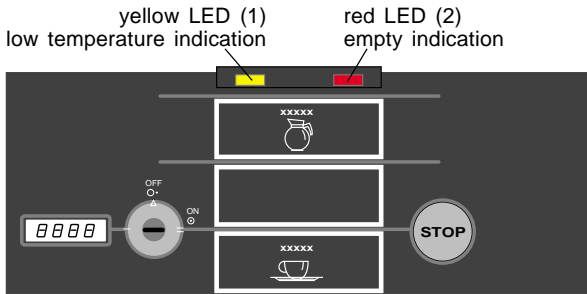

 *Cafitesse* The smarter solution

Description of LEDs



Possible faults

If the dispenser does not function correctly, check the following points before calling the service:

FAULT	CAUSE	REMEDY
 Yellow LED (1) flashes (short flashing frequency) (insufficient cooling)	<ul style="list-style-type: none"> - Dispenser too close to the wall - Ventilation openings of dispenser covered or dirty - Ambient temperature too high 	<ul style="list-style-type: none"> - Move the dispenser approx. 5 cm from the wall - Uncover or clean the ventilation openings - Ensure appropriate cooling of the room
 Yellow LED (1) flashes (long flashing frequency)	<ul style="list-style-type: none"> - Water temperature in the boiler too low and cooling compartment temperature incorrect 	<ul style="list-style-type: none"> - Wait until the dispenser is heated up and provide adequate cooling
 Yellow LED (1) permanently ON	<ul style="list-style-type: none"> - Water temperature in the boiler too low 	<ul style="list-style-type: none"> - Wait until the dispenser is heated up and the yellow LED stops flashing
 No delivery LED (2) shines red	<ul style="list-style-type: none"> - Concentrate pack empty 	<ul style="list-style-type: none"> - Replace the concentrate pack
 No delivery LED (2) flashes red	<ul style="list-style-type: none"> - Technical defect 	<ul style="list-style-type: none"> - Call the service
Dispenser does not function	<ul style="list-style-type: none"> - Dispenser not switched on - Key switch not switched to "ON" - Power supply interrupted - Main fuse defective 	<ul style="list-style-type: none"> - Switch the dispenser on - Switch the key switch to "ON" - Check the power supply - Replace the main fuse
Wrong water/coffee volume	<ul style="list-style-type: none"> - Water cock closed 	<ul style="list-style-type: none"> - Open the water cock
Only delivery of water	<ul style="list-style-type: none"> - Concentrate pack positioned incorrectly - Dosing tube not positioned correctly in the slotted pack opening 	<ul style="list-style-type: none"> - Reposition or replace the concentrate pack - Position the dosing tube correctly

Daily Cleaning of Cafitesse 110

(Always clean after end of coffee services)

Cleaning the components

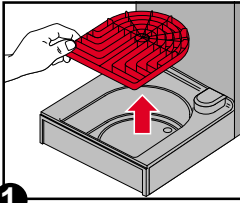

1

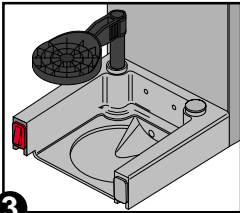

3

- Remove the drip grid (1) and soak it in hot water containing special Cafitesse cleaning agent (15 min.). Rinse it with clear water, then dry the drip grid. (Fig. 1)
- Remove the drip tray. (Fig. 2)
- Use the main switch to switch the dispenser off. (Fig. 3)
- Soak the drip tray in hot water containing special Cafitesse cleaning agent (15 min.). Rinse it with clear water then dry the drip tray
- Remount the drip tray and the drip grid.
- Switch the dispenser on again by means of the main switch.

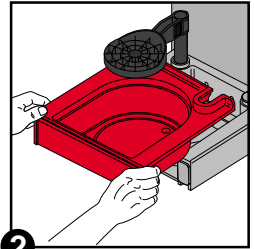

2

Description of Dispenser Components

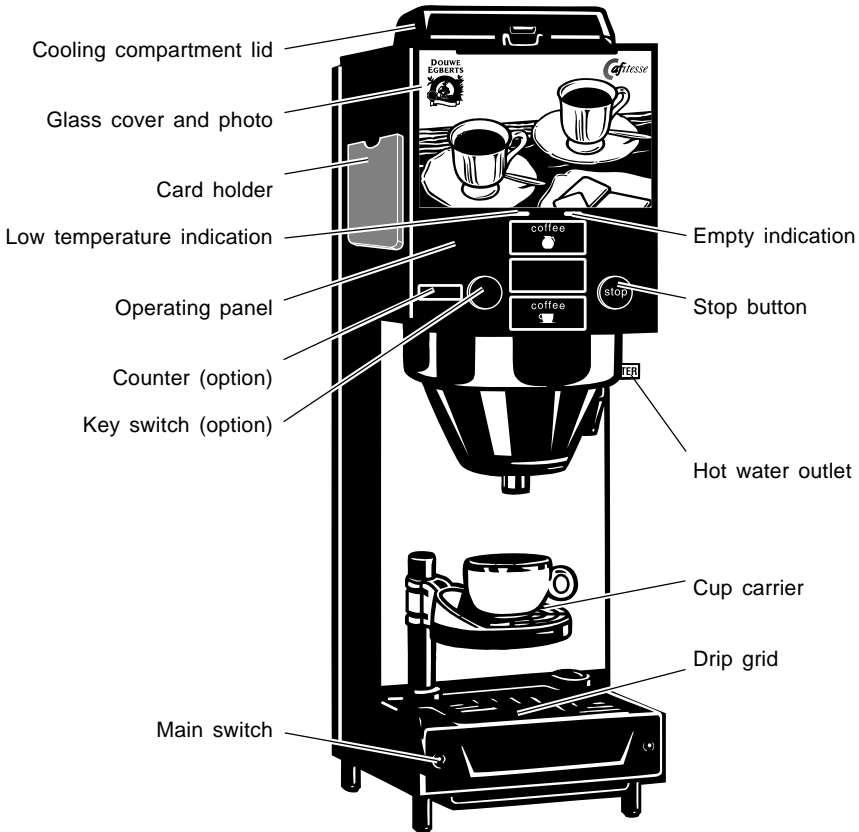

Weekly Cleaning of Cafitesse 110

(Always clean after end of coffee services)

Cleaning the components

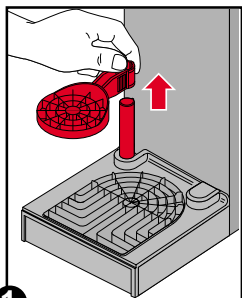

1

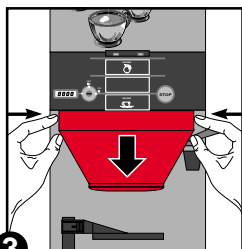

3

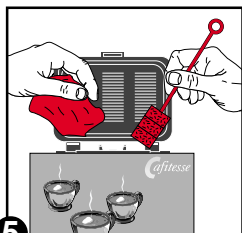

5

- Remove the cup carrier and soak it in hot water containing special Cafitesse cleaning agent (15 min.). Rinse it with clear water and dry it. (Fig. 1)

- Remount the cup carrier.

- Compress the trough with your thumb and index finger and withdraw it. (Fig. 2)

- Soak the trough in hot water containing special Cafitesse cleaning agent (15 min.), rinse with clear water, then dry it.

- Remove the shielding cover and soak it in hot water containing special Cafitesse cleaning agent (15 min.). Rinse it with clear water then dry it. (Fig. 3)

- Remove the concentrate pack. (Fig. 4)

- Clean the cooling compartment with a wet cloth and the brush which has been delivered with the dispenser.

- Dry the cooling compartment. (Fig. 5)

⚠ Do not pour any water and no cleaning agent into the cooling compartment.

- Reinsert the trough and the shielding cover. (Fig. 6)

- Reinsert the concentrate pack.

- Carry out the daily cleaning procedure.

- Switch the dispenser on again by means of the main switch.

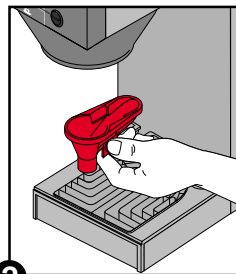

2

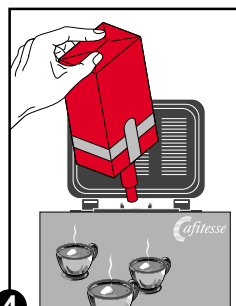

4

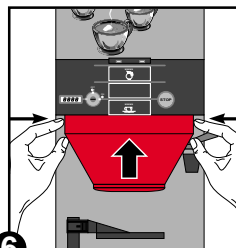

6



Make sure that

- the cleaning agent is **not poured into the cooling compartment** of this dispenser.

The parts to be cleaned must be soaked in a separate container.

- all components are remounted correctly after cleaning.

HACCP Guidelines for Cafitesse 110

Guidelines

- For correct operation of the dispenser, at least these guidelines must be observed. The operator is held responsible for the correct operation.

HACCP guidelines

Storage of Cafitesse products

- Store coffee and tea in a freezer at -18°C . (Fig. 1)
- Thaw coffee and tea in a refrigerator at $+6^{\circ}\text{C}$. (This takes approx. 3 days) (Fig. 2)
- Always use the packs according to the 'first-in first-out' principle. (Observe the 'best before date' on the pack)

Handling of Cafitesse products

- Ensure hygienic handling:
 - wash hands (Fig. 3),
 - work clean,
 - keep the working area tidy.
- Check the pack for damage and shake it 10 times vigorously before use. (Fig. 4)
- Observe the user instructions on the pack.
- Mark the actual date on the pack and insert the pack into the dispenser. (Fig. 5)
- Dispense and check a cup.
- Use packs within the recommended time period (see indications on the pack).

Cleaning of the dispenser

- Observe the cleaning instructions for the Cafitesse 110.
- Clean the dispenser when the delivery is finished.
- Use the special Cafitesse cleaning agent. (Fig. 6)
- Fill in the cleaning record card.

Filing

- File completed cleaning record cards. (Fig. 7)
- File service and maintenance reports of DECS representatives.

Service of the dispenser

- When LEDs (1, 2) are flashing (Fig. 9), observe the Cafitesse reference card for LED indications.

Training

- Keep the reference cards at hand. (Fig. 10)
- Implement the activities on the work schedules.
- Train new staff on HACCP guidelines. (Fig. 8)
- For further questions please contact your DECS representative.

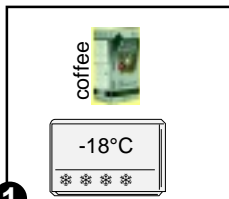

1

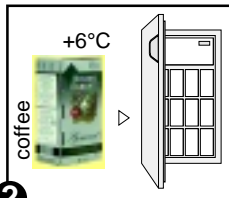

2

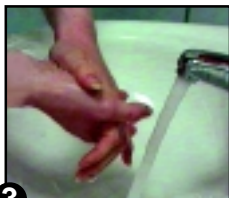

3



4



5



6

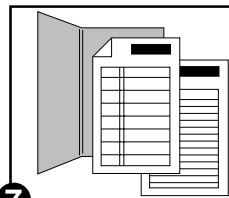

7



8

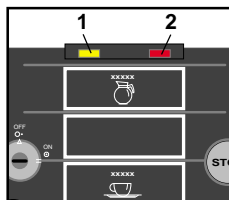

9

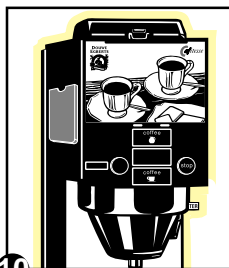

10

Reference Card Cafitesse Cleaning Agent

New bottle

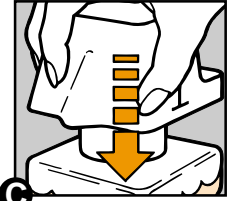
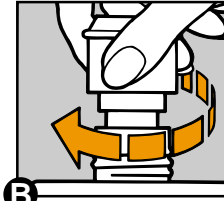
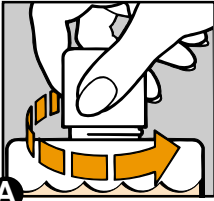

- Use dosing cap and measuring cup of the empty bottle. Order a new set if these are damaged or missing.
- Remove the dosing cap. (A)
- Turn the dosing cap into the bottle. (B)
- Place the measuring cup over the dosing cap on the bottle. (C)

Soaking dispenser parts

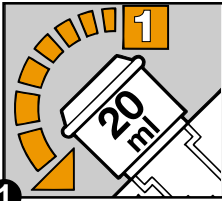

- Remove the measuring cup, turn the bottle upside down and wait for about 5 sec. to fill the dosing cap with approx. 20 ml of cleaning agent. (Fig. 1)

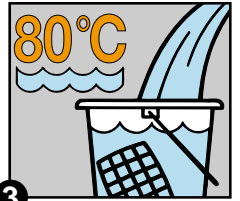

- Turn the bottle upright.
- Pour the contents of the dosing cap into a bucket, bowl or sink.
- Repeat this procedure 1x. (Fig. 1, 2)
- Fill up the bucket, bowl or sink with approx. 8 l of hot water (approx. 80 °C). (Fig. 3)
- Put the parts into bucket, bowl or sink and let them soak for about 15 min.
- Rinse the parts with hot water. (Fig. 4)
- Dry the parts with a paper towel.

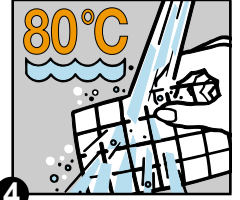
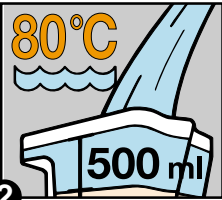

When the bottle is empty, save **dosing cap** and **measuring cup** for use with the next bottle.