

# Quick Reference Cards

## Cafitesse 120

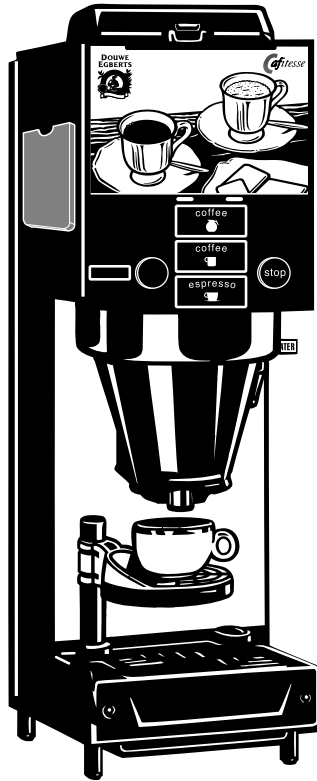



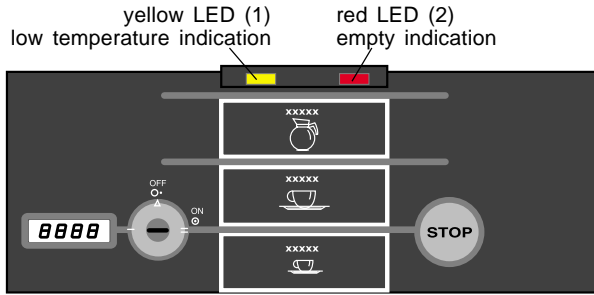

*Cafitesse* The smarter solution

## Description of LEDs



## Trouble Shooting

If the dispenser does not function correctly, check the following points before calling the service:

| FAULT  | CAUSE  | REMEDY  |  |
|--|--|---|--|
|    | Yellow LED (1) flashes (short flashing frequency) (insufficient cooling) | <ul style="list-style-type: none"> <li>- Dispenser too close to the wall</li> <li>- Ventilation openings of dispenser covered or dirty</li> <li>- Ambient temperature too high</li> </ul>   | <ul style="list-style-type: none"> <li>- Move the dispenser approx. 5 cm from the wall</li> <li>- Uncover or clean the ventilation openings</li> <li>- Ensure appropriate cooling of the room</li> </ul> |
|    | Yellow LED (1) flashes (long flashing frequency)                         | <ul style="list-style-type: none"> <li>- Water temperature in the boiler too low and cooling compartment temperature incorrect</li> </ul>   | <ul style="list-style-type: none"> <li>- Wait until the dispenser is heated up and provide adequate cooling</li> </ul>   |
|    | Yellow LED (1) permanently ON  | <ul style="list-style-type: none"> <li>- Water temperature in the boiler too low</li> </ul>   | <ul style="list-style-type: none"> <li>- Wait until the dispenser is heated up and the yellow LED stops flashing</li> </ul>  |
|  | No delivery LED (2) shines red   | <ul style="list-style-type: none"> <li>- Concentrate pack empty</li> </ul>  | <ul style="list-style-type: none"> <li>- Replace the concentrate pack</li> </ul>   |
|  | No delivery LED (2) flashes red  | <ul style="list-style-type: none"> <li>- Technical defect</li> </ul>  | <ul style="list-style-type: none"> <li>- Call the service</li> </ul>   |
|  | Dispenser does not function  | <ul style="list-style-type: none"> <li>- Dispenser not switched on</li> <li>- Key switch not switched to "ON"</li> <li>- Power supply interrupted</li> <li>- Main fuse defective</li> </ul> | <ul style="list-style-type: none"> <li>- Switch the dispenser on</li> <li>- Switch the key switch to "ON"</li> <li>- Check the power supply</li> <li>- Replace the main fuse</li> </ul>                  |
|  | Wrong water/coffee volume  | <ul style="list-style-type: none"> <li>- Water cock closed</li> </ul>   | <ul style="list-style-type: none"> <li>- Open the water cock</li> </ul>  |
|  | Only delivery of water   | <ul style="list-style-type: none"> <li>- Concentrate pack positioned incorrectly</li> <li>- Dosing tube not positioned correctly in the slotted pack opening</li> </ul>                     | <ul style="list-style-type: none"> <li>- Reposition or replace the concentrate pack</li> <li>- Position the dosing tube correctly</li> </ul>   |

# Daily Cleaning of Cafitesse 120

(Always clean after end of coffee services)

## Cleaning the components

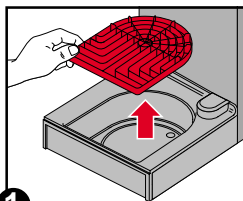

- Remove the drip grid (1) and soak it in hot water containing special Cafitesse cleaning agent (15 min.). Rinse it with clear water, then dry the drip grid. (Fig. 1)

- Remove the drip tray. (Fig. 2)

- Use the main switch to switch the dispenser off. (Fig. 3)

- Soak the drip tray in hot water containing special Cafitesse cleaning agent (15 min.). Rinse it with clear water then dry the drip tray

- Remount the drip tray and the drip grid.

- Switch the dispenser on again by means of the main switch.

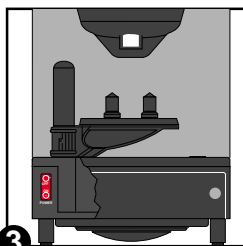
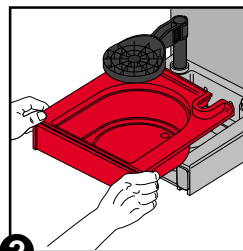

1

2

3

## Discription of Dispenser Components

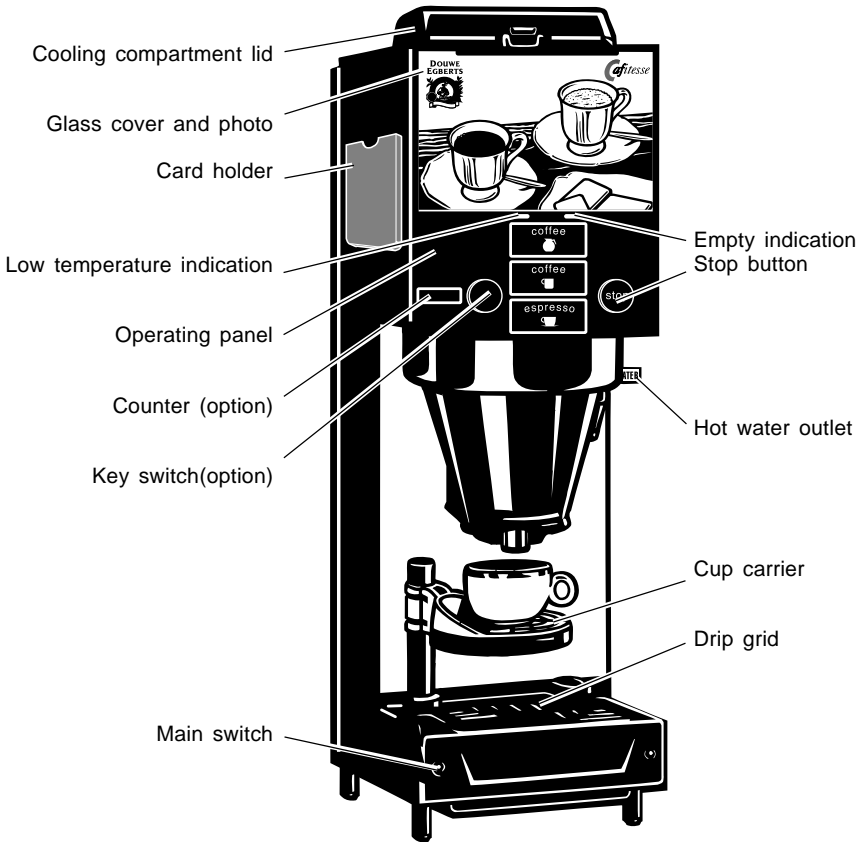

# Weekly Cleaning of Cafitesse 120

(Always clean after end of coffee services)

## Cleaning the components

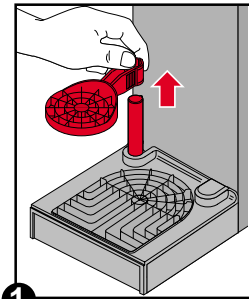

- Remove the cup carrier and soak it in hot water containing special Cafitesse cleaning agent (15 min.). Rinse it with clear water and dry it. (Fig. 1)

- Remount the cup carrier.
- Remove the concentrate pack. (Fig. 2)
- Clean the cooling compartment with a wet cloth and the brush which has been delivered with the dispenser.

- Dry the cooling compartment. (Fig. 3)

 **Do not pour any water and no cleaning agent into the cooling compartment.**

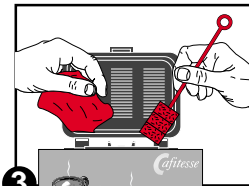

- Remove the shielding cover and soak it in hot water containing special Cafitesse cleaning agent (15 min.). Rinse it with clear water then dry it. (Fig. 4)

- Press the lower edge of the mixer support upwards and tilt the mixer unit forwards. (Fig. 5)

- Pull off the sieve housing (4). (Fig. 6)

- Remove the mixing funnel (1) towards the top. (Fig. 6)

- Turn the mixing container (5) to the right and remove it to the front. (Fig. 6)

- Remove the mixer (3) and the spacer ring (2) to the front. (Fig. 6)

- Soak all parts in hot water containing special Cafitesse cleaning agent (15 min.), rinse them with clear water, then dry them.

- Hold the sieve housing with the sieve insert facing upwards under running water, in order to remove dirt from it.

- Assemble the mixing unit in reverse order and press it upwards until it engages. (Fig. 7)

- Move the shielding cover into a position where the catches are aligned with the openings in the housing.

- Press the sides of the shielding cover together and move it upwards until it engages. (Fig. 8)

- Reinsert the concentrate pack.

- Carry out the daily cleaning procedure.

- Switch the dispenser on again by means of the main switch.

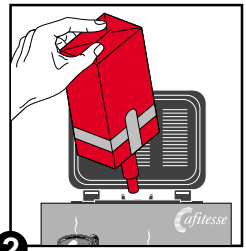

2

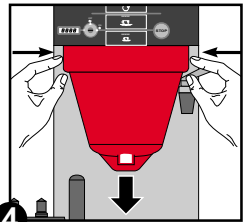

4

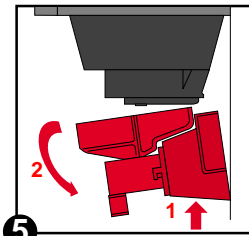

5

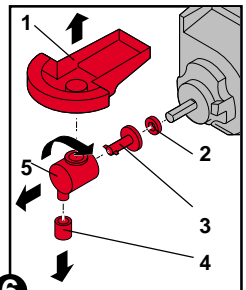

6

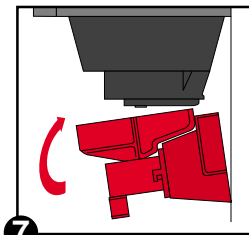

7

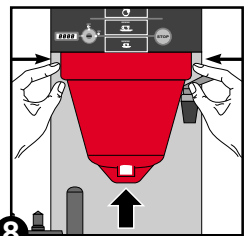

8



**Make sure that**

- the cleaning agent is **not poured into the cooling compartment** of this dispenser. The parts to be cleaned must be soaked in a separate container.
- all components are remounted correctly after cleaning.

# HACCP Guidelines for Cafitesse 120

## Guidelines

- For correct operation of the dispenser, at least these guidelines must be observed. The operator is held responsible for the correct operation.

## HACCP guidelines

### Storage of Cafitesse products

- Store coffee and tea in a freezer at -18 °C. (Fig. 1)
- Thaw coffee and tea in a refrigerator at +6 °C. (This takes approx. 3 days) (Fig. 2)
- Always use the packs according to the 'first-in first-out' principle. (Observe the 'best before date' on the pack)

### Handling of Cafitesse products

- Ensure hygienic handling:
  - wash hands (Fig. 3),
  - work clean,
  - keep the working area tidy.
- Check the pack for damage and shake it 10 times vigorously before use. (Fig. 4)
- Observe the user instructions on the pack.
- Mark the actual date on the pack and insert the pack into the dispenser. (Fig. 5)
- Dispense and check a cup.
- Use packs within the recommended time period (see indications on the pack).

### Cleaning of the dispenser

- Observe the cleaning instructions for the Cafitesse 120.
- Clean the dispenser when the delivery is finished.
- Use the special Cafitesse cleaning agent. (Fig. 6)
- Fill in the cleaning record card.

### Filing

- File completed cleaning record cards. (Fig. 7)
- File service and maintenance reports of DECS representatives.

### Service of the dispenser

- When LEDs (1, 2) are flashing (Fig. 9), observe the Cafitesse reference card for LED indications.

### Training

- Keep the reference cards at hand. (Fig. 10)
- Implement the activities on the work schedules.
- Train new staff on HACCP guidelines. (Fig. 8)
- For further questions please contact your DECS representative.



1

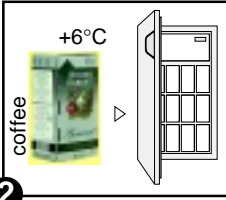

2

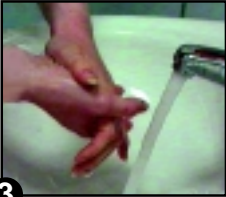

3



4



5



6

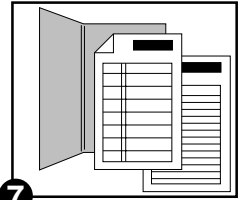

7



8

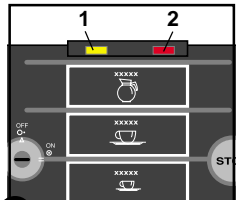

9



10



# Reference Card Cafitesse Cleaning Agent

## New bottle

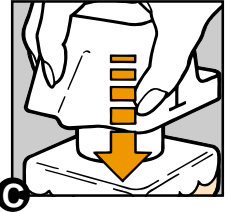
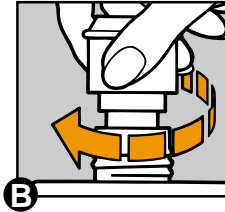
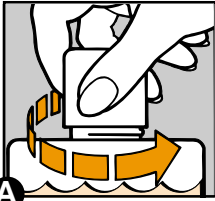

- Use dosing cap and measuring cup of the empty bottle. Order a new set if these are damaged or missing.
- Remove the dosing cap. (A)
- Turn the dosing cap into the bottle. (B)
- Place the measuring cup over the dosing cap on the bottle. (C)

## Soaking dispenser parts

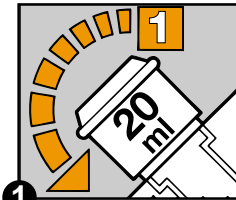

- Remove the measuring cup, turn the bottle upside down and wait for about 5 sec. to fill the dosing cap with approx. 20 ml of cleaning agent. (Fig. 1)

- Turn the bottle upright.

- Pour the contents of the dosing cap into a bucket, bowl or sink.

- Repeat this procedure 1x. (Fig. 1, 2)

- Fill up the bucket, bowl or sink with approx. 8 l of hot water (approx. 80 °C). (Fig. 3)

- Put the parts into bucket, bowl or sink and let them soak for about 15 min.

- Rinse the parts with hot water. (Fig. 4)

- Dry the parts with a paper towel.

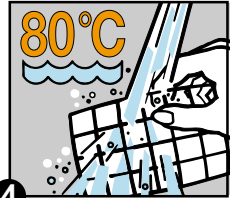
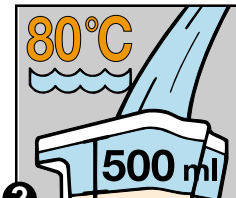
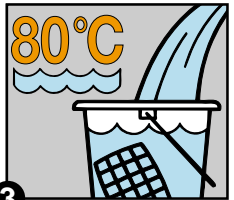

When the bottle is empty, save **dosing cap** and **measuring cup** for use with the next bottle.